

Zip HydroTap G4

The worlds most advanced drinking water appliance.

Model:
ZT006 Drainless font kit

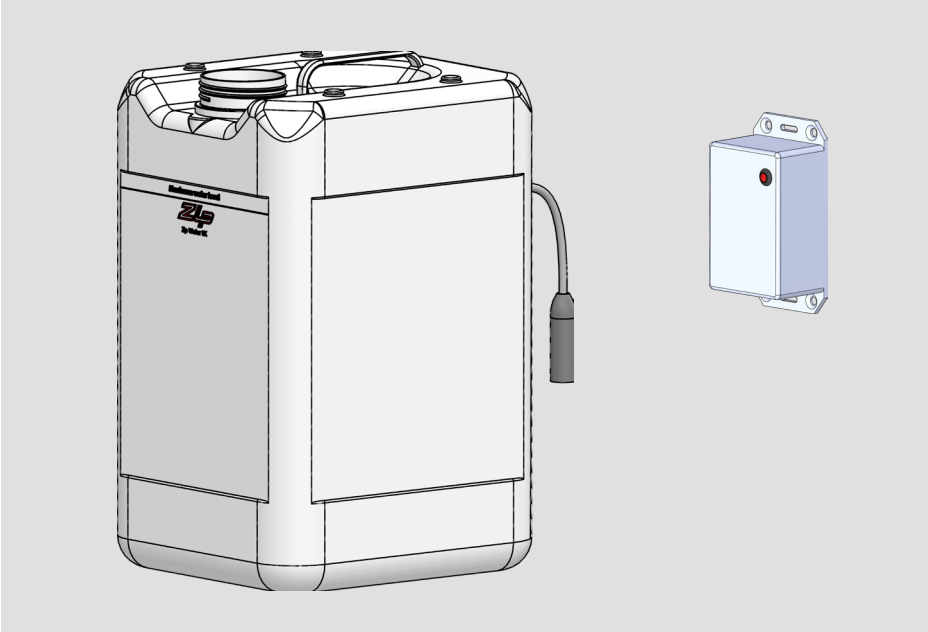

Zip Water
Trafalgar House, Rash's Green, Dereham, Norfolk, NR19 1JG
0345 6 005 005 sales@zipindustries.co.uk

www.zipwater.co.uk

Thank you for buying the Zip ZT006 Drainless font kit

- This quick start guide will give you an overview of the basic steps involved in the installation & use of the ZT006 Drainless font kit . Before starting work:

Read and understand the warnings and precautions in the HydroTap and font installation instructions.



Unless specifically trained by Zip it is also essential to fully read and understand the G4 Installation and User instructions in order to safely install the ZT006 Drainless font kit within the context of the complete system.

- Installation and user instructions can be found online at <https://specify.zipwater.co.uk/>.

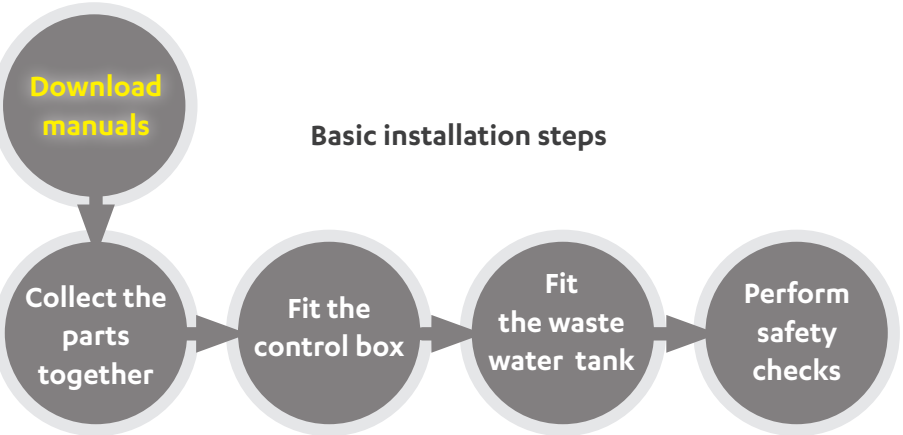

1. Collect the required parts together



2. Familiarise yourself with the installation

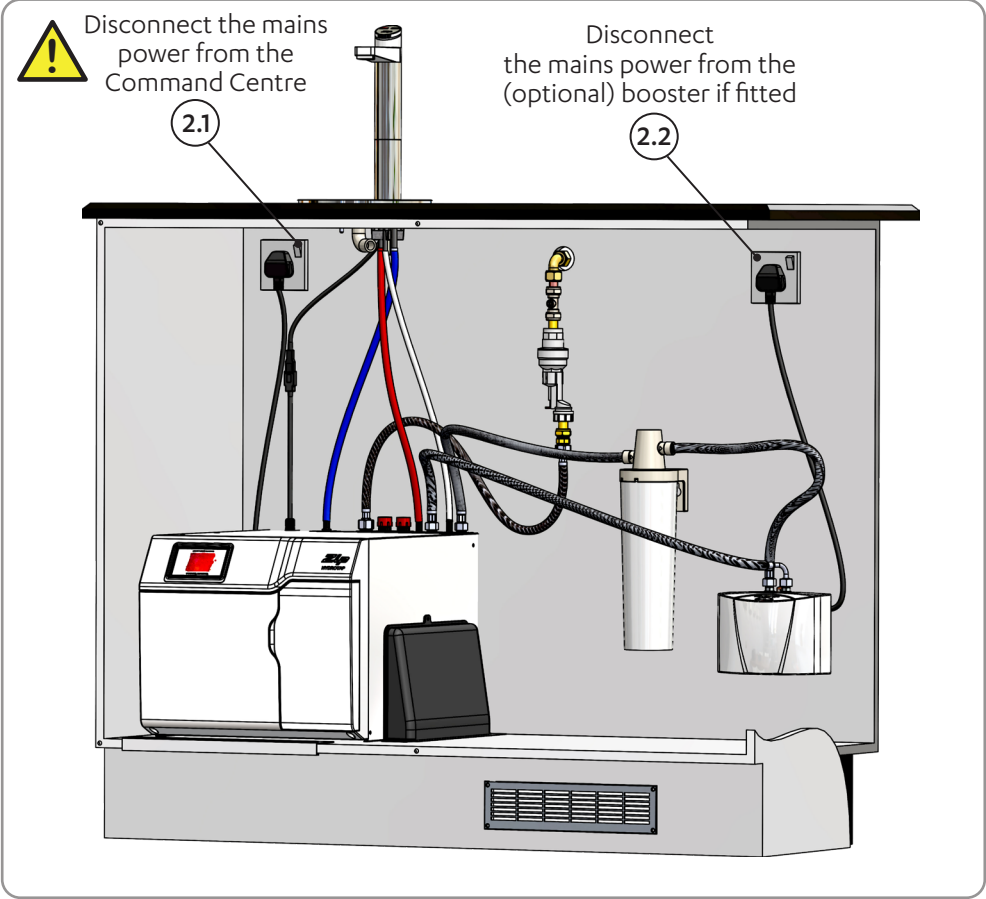

3. Fit the control box

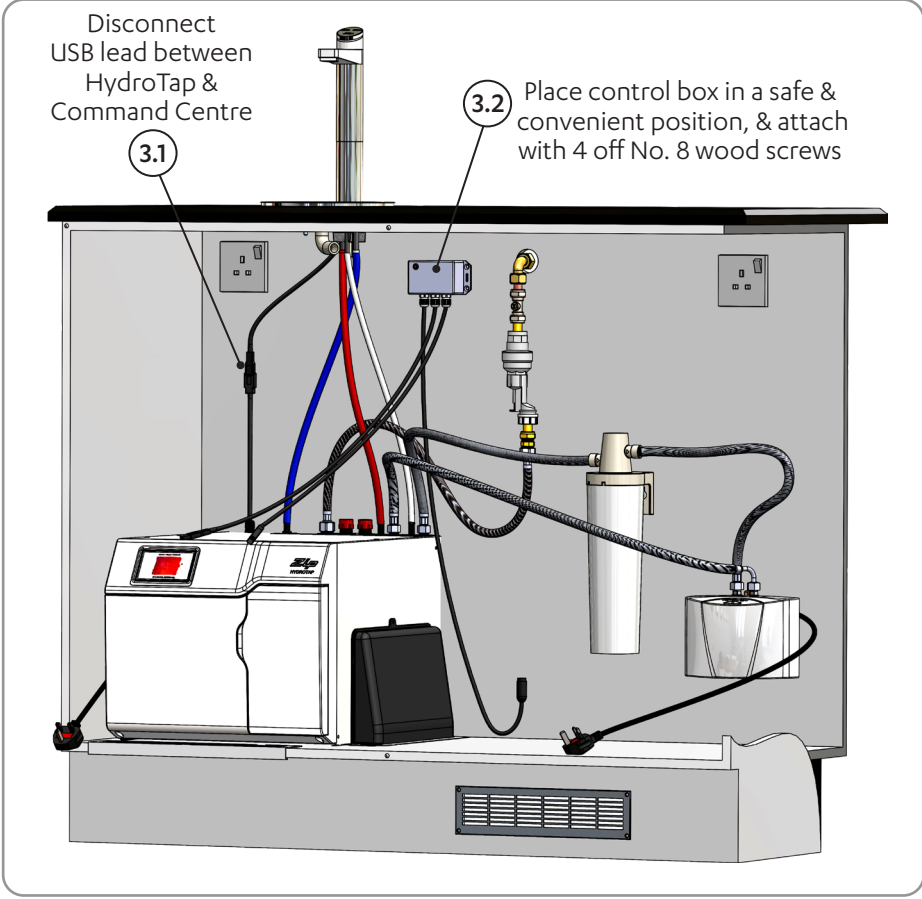

4. Connect the tank level sensor & place in position

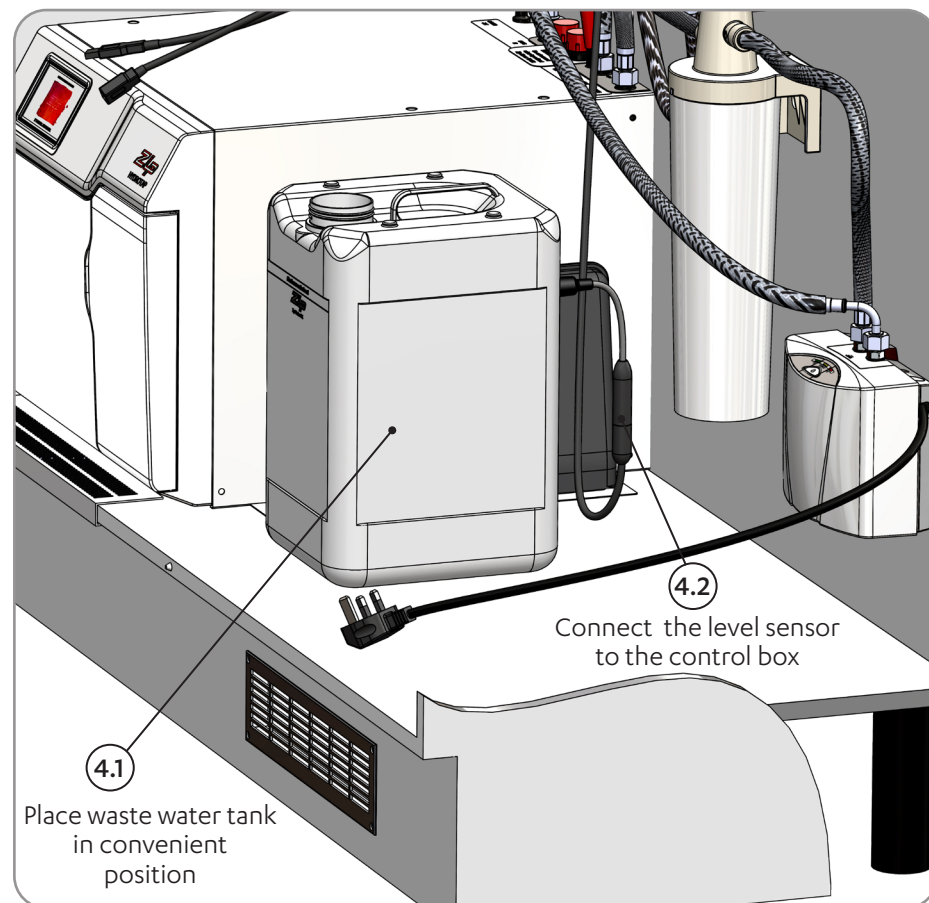

5. Familiarise yourself with the component parts, begin the assembly

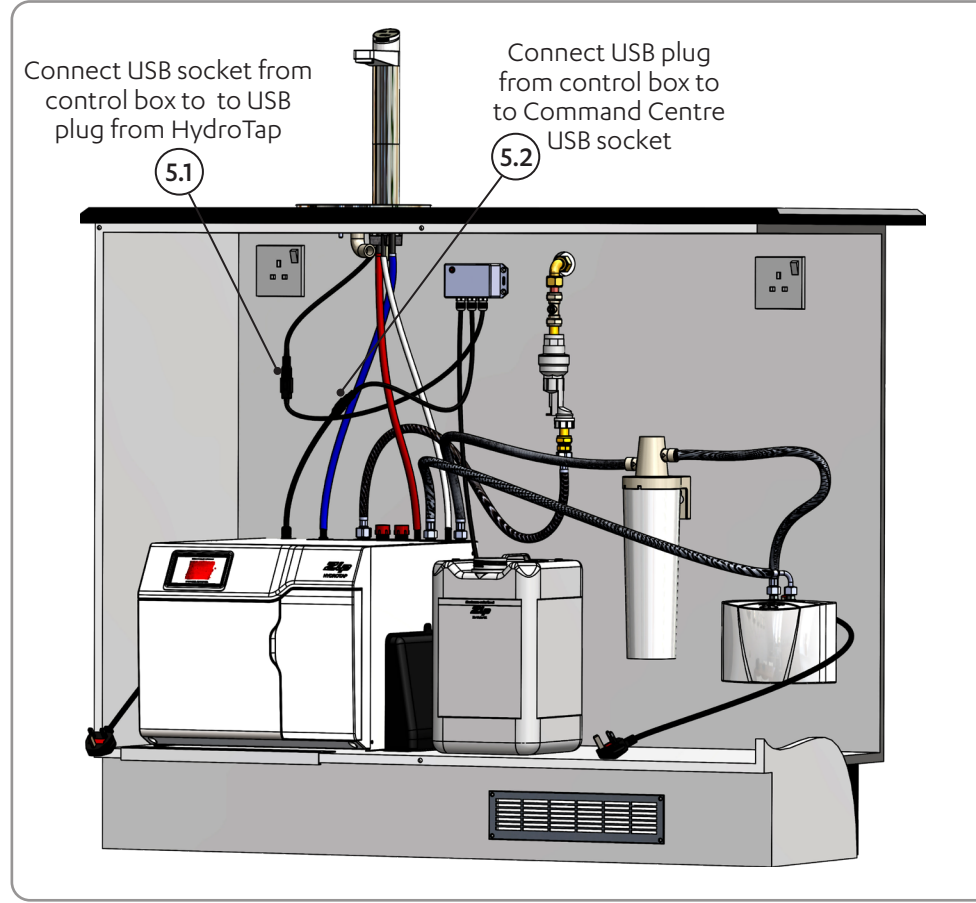

6. Fit the waste water pipe

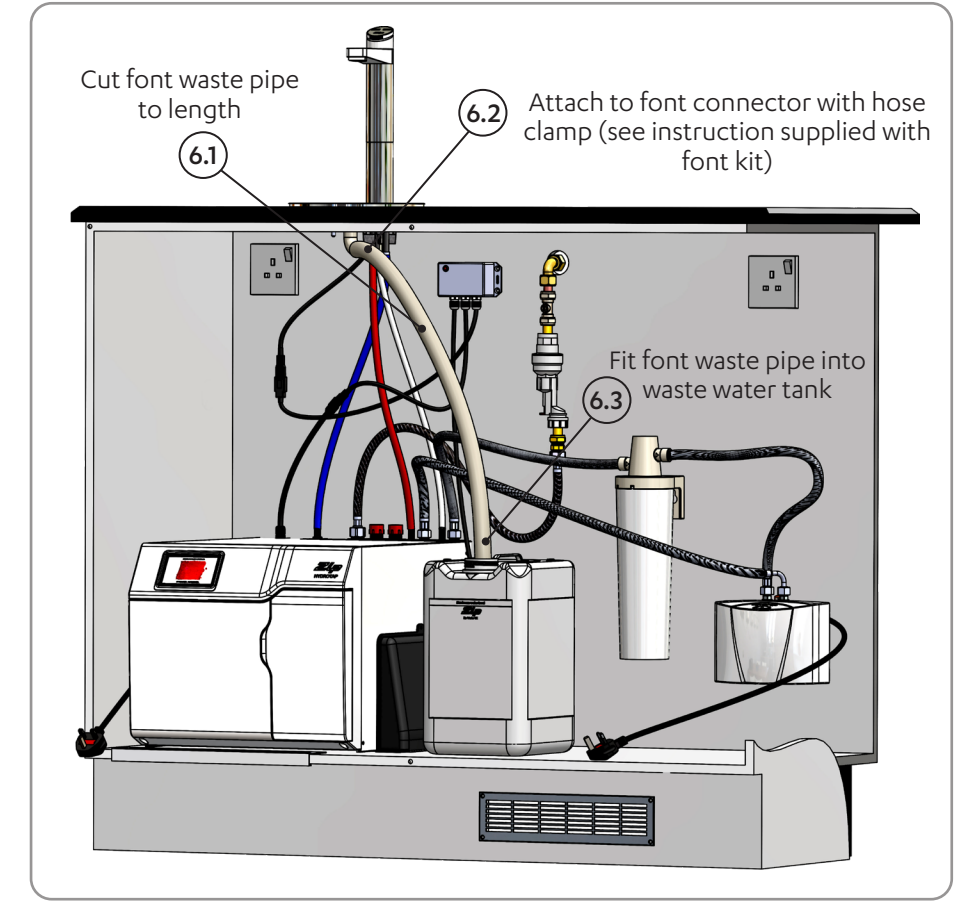

7. Check the installation is safe & turn the power back on

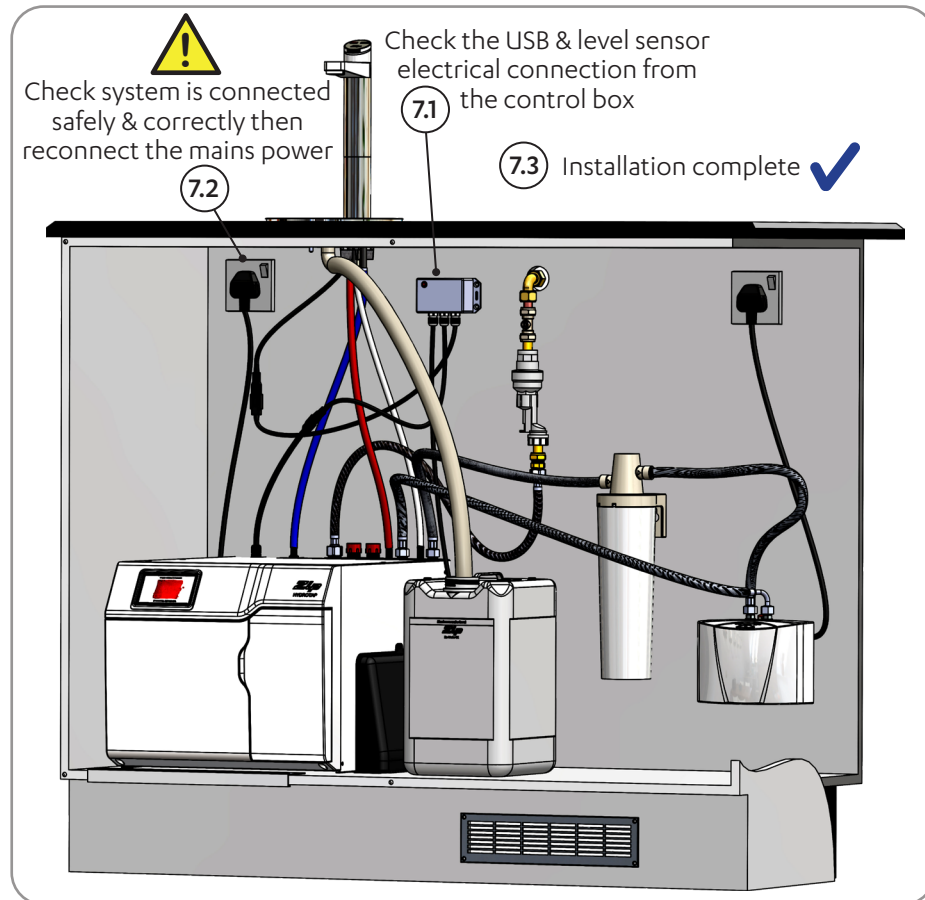

8. When the tank is full

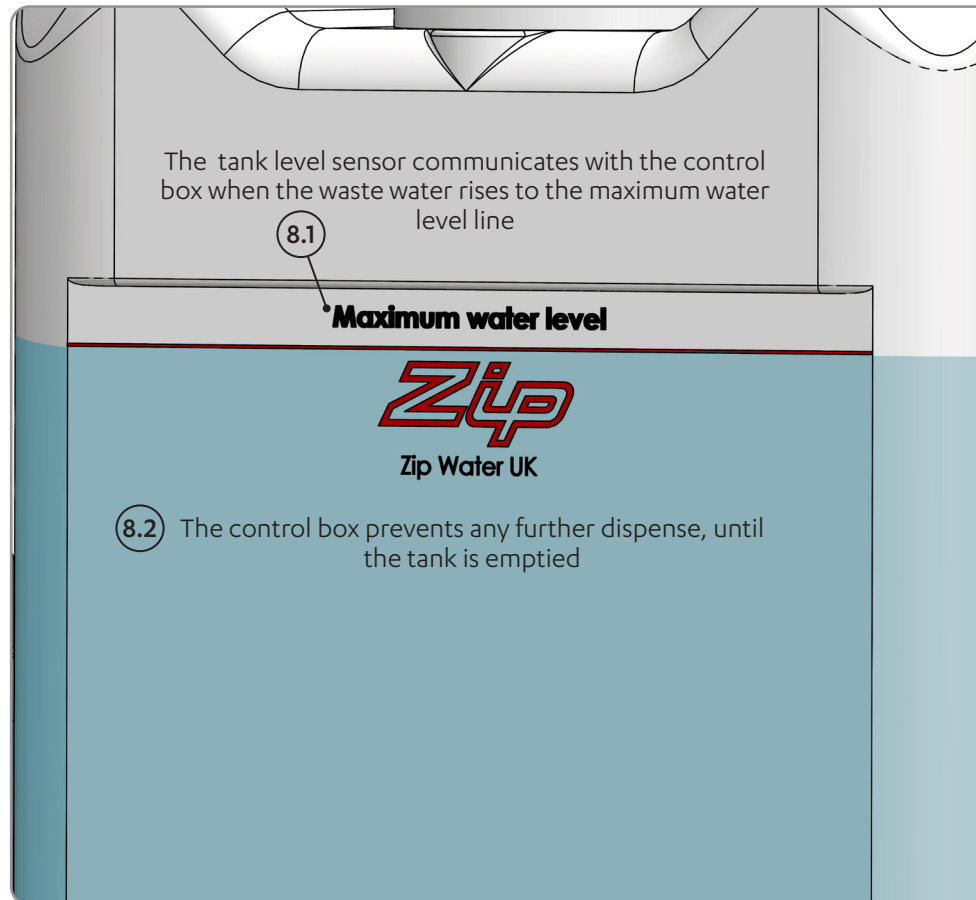

9. When the full indicator LED illuminates, empty the tank

